

Interface Setup

START UP:

- 1) Start with all HUB Series equipment "OFF".
- 2) Connect interface unit to the back of wired system or wall port via **RED** 3-Pin XLR.
- 3) Connect interface unit to the HUB via 2-Pin connector.
- 4) Turn the HUB "ON", then install batteries into wireless headsets.



ADJUSTMENTS:

Volume is increased and decreased by the red and white buttons on the interface. Adjustments are made in digital "steps"; click and release button.

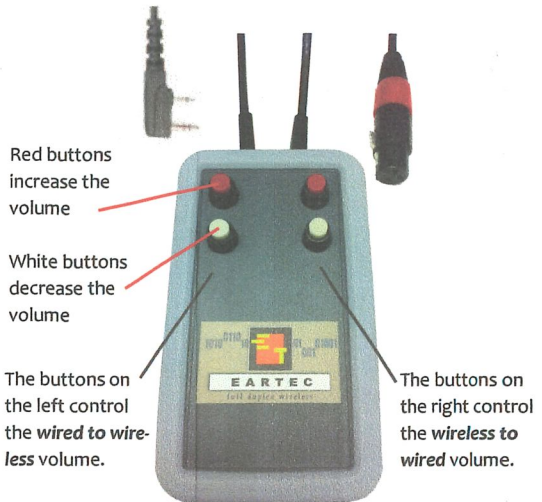

145 Dean Knauss Drive
Narragansett, RI 02882
Tel: 1-800-399-5994
www.eartec.com